

THIS DOCUMENT IS SUBJECT TO CHANGE WITHOUT NOTICE. IT IS CONFIDENTIAL AND A PROPERTY OF Amphenol LTW. DISCLOSURE TO THIRD PARTY HAS TO BE AUTHORIZED BY Amphenol LTW.

REV.	ECN NO.	DATE	SIGN	DESCRIPTION
D	LE31520002	2015/01/28	Sam	Old Item No.SS-050505-FMF-YS001

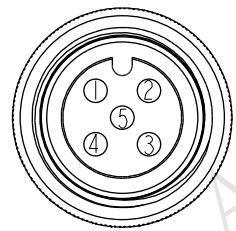

Conn. 1 & Conn. 2  
Pin Assignments  
Front View

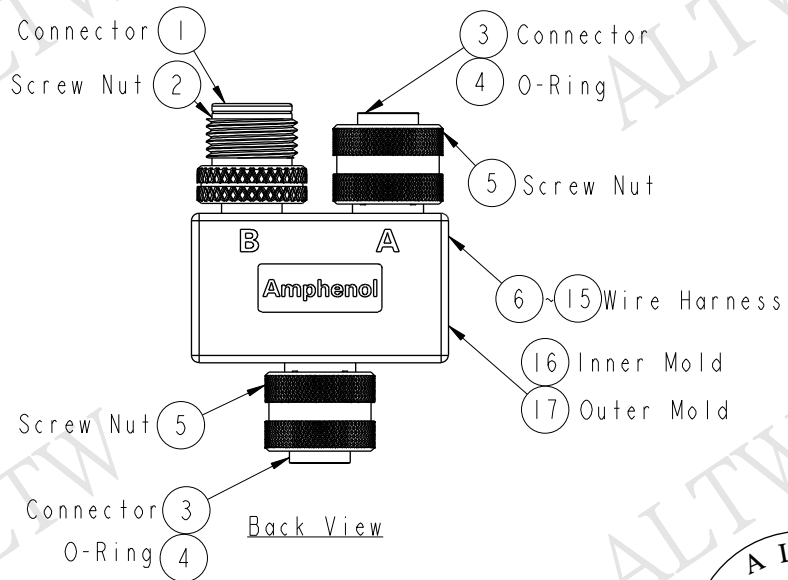
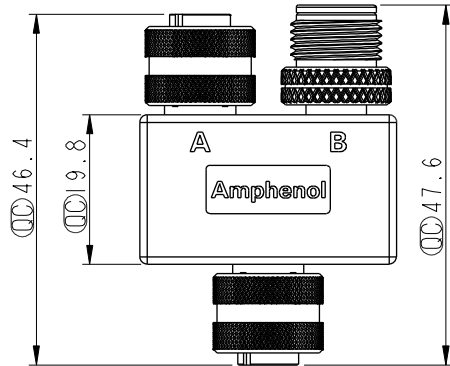
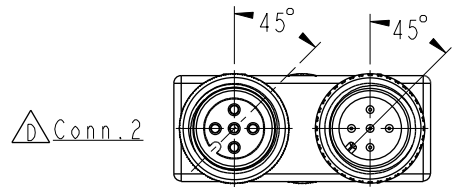
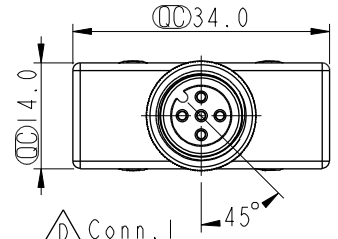

Conn. 1

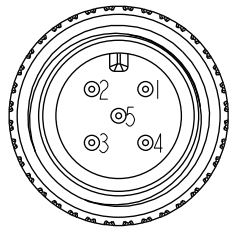

Conn. 3  
Pin Assignments  
Front View

5	Red	紅	5	5
4	Green	綠	4	4
3	Blue	藍	3	3
2	White	白	2	2
1	Black	黑	1	1
Conn. 1 Wire Color		Conn. 2	Conn. 3	
Pin Out				

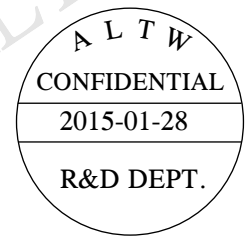

- Notes:
- \*  $\varnothing$  Important Dimension.
  - \* Waterproof Rate: IP68.  
IP68: 1M Depth Of Water In 24hours.
  - \* Housing: PU, Black.
  - \* Pin: Copper Alloy, Gold Plated.
  - \* O-Ring: Viton, Green.
  - \* Screw Copper Alloy, Nickel Plated.
  - \* Wire Harness: UL1007 24 AWG.

UNIT: mm	
TOLERANCE	±0.5 mm

TITLE M12 CONN Y ADAPTOR FFM CONN FFM PIN, 5PIN			
SCALE 1:1	SIZE A4	SHEET 1 OF 1	
REV. D	WC-REV. A.1	$\varnothing$ : Inspection item	

**Amphenol LTW**  
安費諾亮泰企業股份有限公司

ITEM NO. SS-050505-FFM-YS001	DRAWN BY Sam	DATE 2015-01-28
DWG NO. SS-050505-FFM-YS001	CHECKED BY Vicky	DATE 2015-01-28
CUSTOMER ALTW	APPROVED BY Rita	DATE 2015-01-28