

THIS DOCUMENT IS SUBJECT TO CHANGE WITHOUT NOTICE. IT IS CONFIDENTIAL AND A PROPERTY OF Amphenol LTW. DISCLOSURE TO THIRD PARTY HAS TO BE AUTHORIZED BY Amphenol LTW.

REV.	ECN NO.	DATE	SIGN	DESCRIPTION
B	C201781	2020/11/12	Ruru	\triangle_B X3
C	C210497	2021/03/30	Ruru	\triangle_C X2

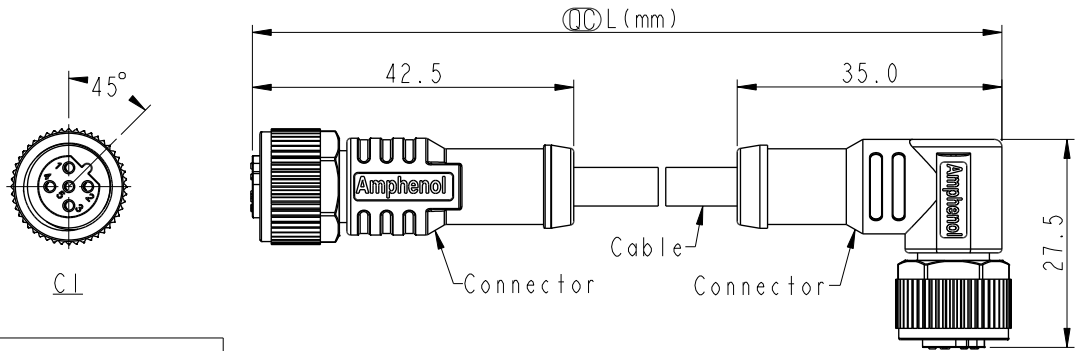

\triangle_B
MSBPXXFL-SBPFR-SDXXX

XX: No. Of Pin

- XXX: 0.5~99Meters
- A05: 0.5 Meter
- 1: 01 Meter
- 2: 02 Meters
- ...
- 99: 99 Meters

Pin Out	Wire Color	Wire Color (Chinese)
5	Gray	灰
4	Black	黑
3	Blue	藍
2	White	白
1	Brown	棕

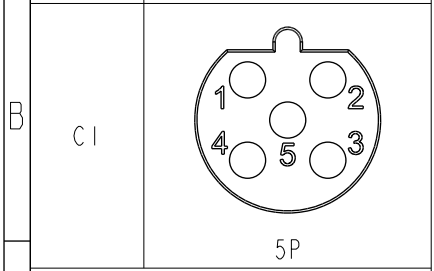
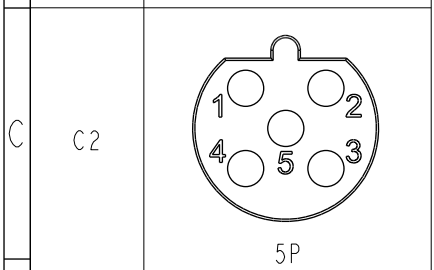

Pin Assignments Front View

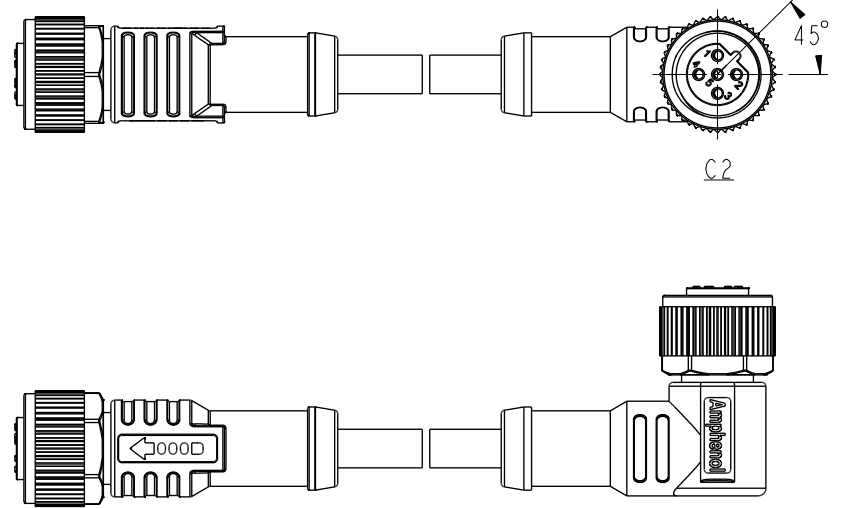

Note: \triangle_B \triangle_C

- * RoHS Compliant
- * \odot Important dimension
- * C1
 - Waterproof rate: IPX8, mated 1m/24h
 - IPX9K, mated
 - Housing: Thermoplastic, Black
 - Pin: Copper alloy, Gold plated
 - O-Ring: Rubber, Green
 - Nut: Thermoplastic, Black
 - Outer mold: Thermoplastic, Black
- * C2
 - Waterproof rate: IPX8, mated 1m/24h
 - IPX9K, mated
 - Housing: Thermoplastic, Black
 - Pin: Copper alloy, Gold plated
 - O-Ring: Rubber, Green
 - Nut: Thermoplastic, Black
 - Outer mold: Thermoplastic, Black
- * Cable: UL2517, 22#5C, OD=5.1mm, PVC Jacket, Black
- * Cable length tolerance:
 - 0.5M < L ≤ 1M: +60/-0 mm
 - 1M < L ≤ 3M: +120/-0 mm
 - 3M < L ≤ 5M: +160/-0 mm
 - 5M < L ≤ 10M: ±100 mm
 - 10M < L ≤ 20M: ±200 mm
 - 20M < L ≤ 30M: ±300 mm
 - 30M < L ≤ 99M: ±500 mm

UNIT:mm		
TOLERANCE		
± 0.5 mm		

TITLE ACC, SEN, B Code, DB-ENDED FF			
SCALE 1:2	SIZE A4	SHEET 1 OF 1	
REV. C	WC-REV.	\odot : Inspection item	

Amphenol LTW
安費諾亮泰企業股份有限公司

ITEM NO	DRAWN BY Ruru	DATE 2018-12-10
DWG NO \triangle_B MSBPXXFL-SBPFR-SDXXX	CHECKED BY Rita	DATE 2018-12-10
CUSTOMER ALTW	APPROVED BY Max	DATE 2018-12-10